



ZANUS
PRODUCTION ROBOTICS

Zanus PT heads – Accessory List



Pauli Technical specifications

Parameter	Value
Payload	20kg
Weight	8.4kg
Dimensions	434×276×144mm
Pan axis range	±175°
Tilt axis range	±180°
Pan/tilt axis velocity range	0.001-180°/s
Maximum acceleration	90°/s ²
Shot Recall Repeatability	±0.025°
Power requirements	100-240 VAC
Operating temperature range	-10 to +45°C
Storage temperature range	-20 to +60°C
Ambient humidity	10% to 90% non-condensing
Presets	Preset play/run, preset array, maximum 100 points, preset in some axis and manual control in others possible
Connection	IP Ethernet
Noise level	40dB
Communication connectors	Ethernet switch in the head with ethernet connection for the camera, with a locking mechanism, CAN connector for interface with Zanus pedestal and dolly
Power output connectors	12VDC, 60W D-Tap and XLR
Zoom, Focus, Iris control	Interface for Canon and Fujinon lenses, interface for PDMOVIE external lens motors; LANC & Panasonic analog. Canon XC protocol.
Mounting	Standard tripod mount, reverse mount possible, 90° wall-mount with adapter possible
Protection class	IP52
Connectors (audio, video)	2× 12G SDI/Genlock co-ax pass-through

PauliB Technical specifications

Parameter	Value
Payload	20kg
Weight	6.2kg
Dimensions	367×288×167mm
Pan axis range	±360° (multi turn)
Tilt axis range	±180°
Pan/tilt axis velocity range	0.001-180°/s
Maximum acceleration	90°/s ²
Shot Recall Repeatability	±0.025°
Power requirements	12VDC, 5A
Operating temperature range	-10 to +45°C
Storage temperature range	-20 to +60°C
Ambient humidity	10% to 90% non-condensing
Presets	Preset play/run, preset array, maximum 100 points, preset in some axis and manual control in others possible
Connection	IP Ethernet
Noise level	40dB
Communication connectors	CAN for interface with Zanus dolly and lift systems
Power output connectors	None
Zoom, Focus, Iris control	Interface for Canon and Fujinon lenses, interface for PDMOVIE external lens motors; LANC & Panasonic analog; Canon XC protocol
Mounting	Standard tripod mount with half ball, reverse mount possible, 90° wall-mount with adapter possible
Protection class	IP52

Paulinho Technical specifications

Parameter	Value
Payload	5kg
Weight	3.3kg
Dimensions	288×277×90mm
Pan axis range	±175°
Tilt axis range	±180°
Pan/tilt axis velocity range	0.01-30°/s
Maximum acceleration	30°/s ²
Power requirements	24 VDC, 5A
Operating temperature range	-10 to +45°C
Presets	Preset play/run, preset array, maximum 100 points, preset in some axis and manual control in others possible
Connection	IP Ethernet
Noise level	40dB
Communication connectors	Ethernet switch in the head whit ethernet connection for the camera, with a locking mechanism, CAN connector for interface with Zanus pedestal and dolly
Power output connectors	DDC 7.4V, 8.4V, 10V, 12V, 24V – 50W
Zoom, Focus, Iris control	Interface for Canon and Fujinon lenses, interface for PDMOVIE external lens motors; LANC & Panasonic analog, Canon XC protocol
Mounting	Standard tripod mount, reverse mount possible, 90° wall-mount with adapter possible
Connectors (audio, video)	1x 12G SDI co-ax pass through, 1x HDMI pass through
Protection class	IP52

PaulinhoB Technical specifications

Parameter	Value
Payload	5kg
Weight	2.9kg
Dimensions	257×264×168mm
Pan axis range	±360° (multi turn)
Tilt axis range	±180°
Pan/tilt axis velocity range	0.01-30°/s
Maximum acceleration	30°/s ²
Power requirements	24 VDC, 5A
Operating temperature range	-10 to +45°C
Presets	Preset play/run, preset array, maximum 100 points, preset in some axis and manual control in others possible
Connection	IP Ethernet
Noise level	40dB
Communication connectors	CAN connector for interface with Zanus pedestal and dolly
Zoom, Focus, Iris control	Interface for Canon and Fujinon lenses, interface for PDMOVIE external lens motors; LANC & Panasonic analog, Canon XC protocol
Mounting	Standard tripod mount, reverse mount possible, 90° wall-mount with adapter possible
Protection class	IP52

Paulinho PT Head for Blackmagic studio cameras Technical specifications

Parameter	Value
Payload	5kg
Weight	3.2kg
Dimensions	258×311×168mm
Pan axis range	±360° (multi turn)
Tilt axis range	±180°
Pan/tilt axis velocity range	0.01-30°/s
Maximum acceleration	30°/s ²
Power requirements	24 VDC, 5A
Operating temperature range	-10 to +45°C
Presets	Preset play/run, preset array, maximum 100 points, preset in some axis and manual control in others possible
Connection	IP Ethernet
Noise level	40dB
Communication connectors	CAN connector for interface with Zanus pedestal and dolly
Zoom, Focus, Iris control	Interface for Canon and Fujinon lenses, interface for PDMOVIE external lens motors; LANC; Canon XC protocol
Mounting	Standard tripod mount, reverse mount possible, 90° wall-mount with adapter possible
Protection class	IP52

PT heads packages

There are several packages available, depending if the customer wants the Basic package or needs additional accessories for controlling the camera.

Pauli basic package

ID	Part	Quantity
1	PTU "Pauli"	1
2	C14 Power Cord	1
3	Camera mounting plate	1
4	1/4" camera mount screw – short	1
5	3/8" to 1/4" screw adapter	1
6	3/8" camera mount screw – short	1



PauliB basic package

ID	Part	Quantity
1	PTU "PauliB"	1
2	Power supply brick	1
3	Camera mounting plate	1
4	1/4" camera mount screw – short	1
5	3/8" to 1/4" screw adapter	1
6	3/8" camera mount screw – short	1

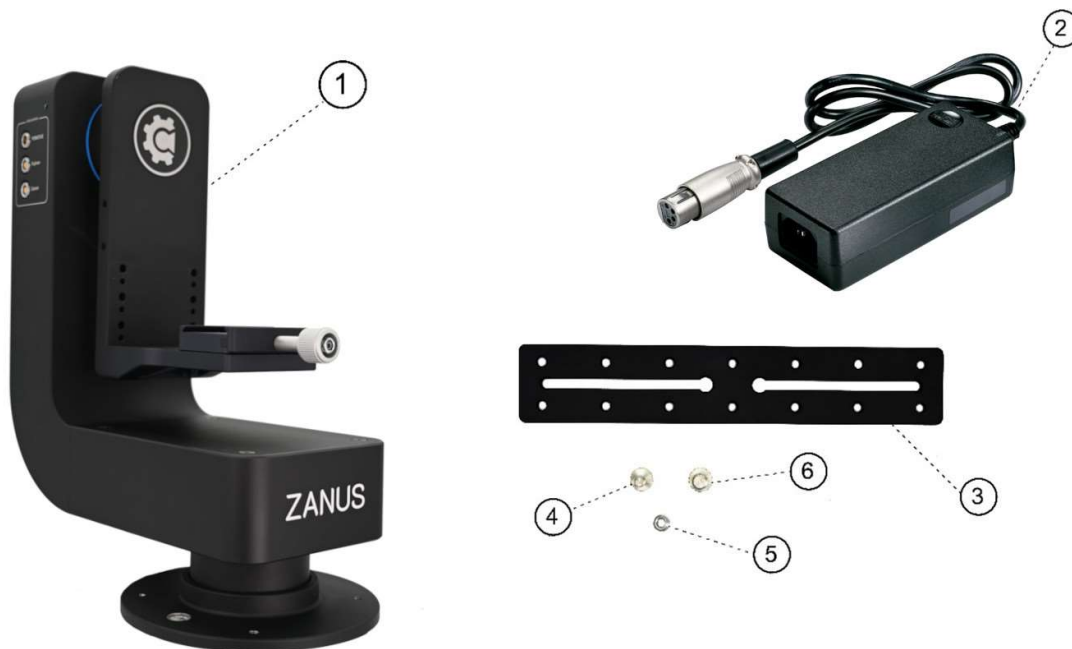

Paulinho basic package

ID	Part	Quantity
1	PTU "Paulinho"	1
2	Power supply brick	1
3	Camera mounting plate	1
4	1/4" camera mount screw – short	1
5	3/8" to 1/4" screw adapter	1
6	3/8" camera mount screw – short	1

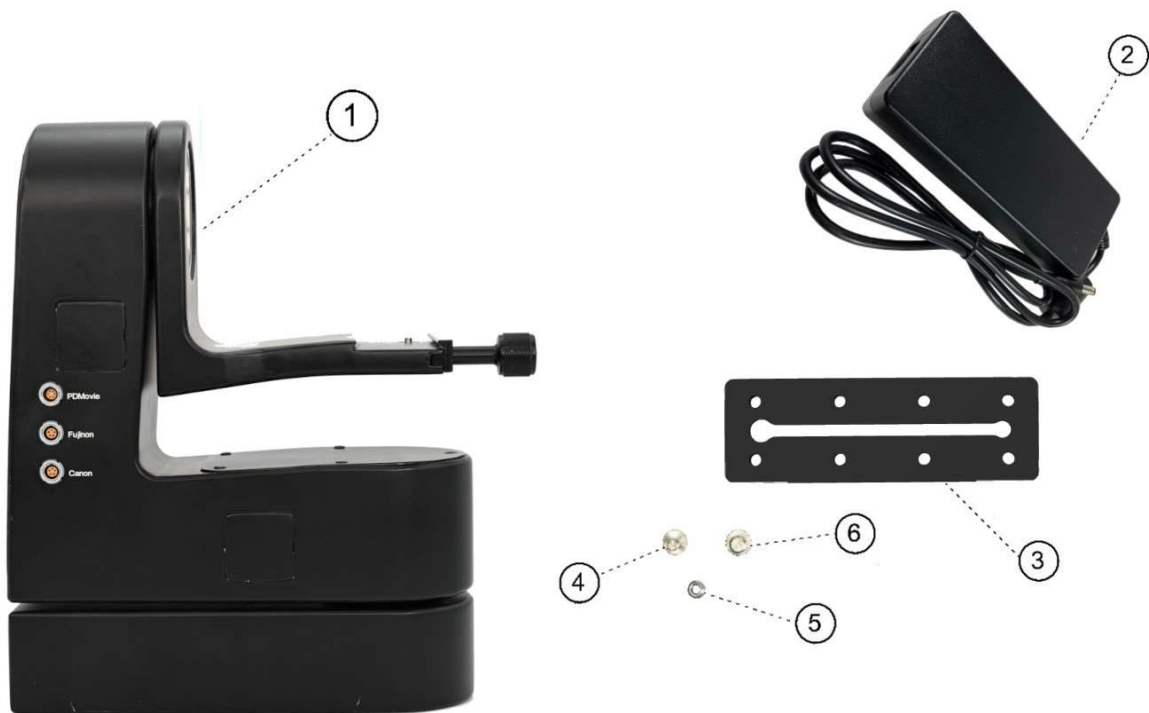

PaulinhoB basic package

ID	Part	Quantity
1	PTU "PaulinhoB"	1
2	Power supply brick	1
3	Camera mounting plate	1
4	1/4" camera mount screw – short	1
5	3/8" to 1/4" screw adapter	1
6	3/8" camera mount screw – short	1



Paulinho PT Head for Blackmagic studio cameras

ID	Part	Quantity
1	PTU "Paulinho for Blackmagic studio cameras "	1
2	Power supply brick	1
3	Camera mounting plate	1
4	1/4" camera mount screw – short	1
5	3/8" to 1/4" screw adapter	1
6	3/8" camera mount screw – short	1



Lens holder package

ID	Part	Quantity
1	Carbon tubes short	2
2	Carbon tubes medium	2
3	Carbon tubes long	2
4	Carbon tube mount	1
5	Tube holder spacer for carbon tube mount	1
6	M6 x 45 bolts	2
7	M6 x 20 bolts	2
8	M4 x 12 bolts	4

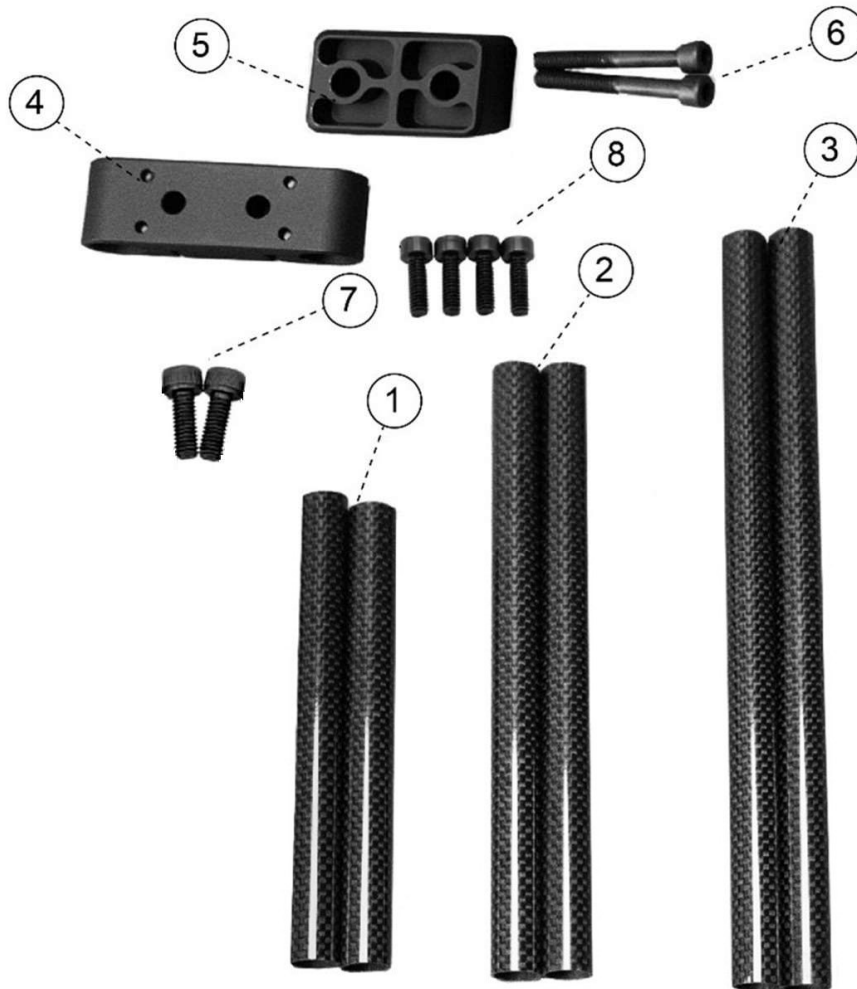

Lens holder package extended

ID	Part	Quantity
1	Carbon tubes short	2
2	Carbon tubes medium	2
3	Carbon tubes long	2
4	Carbon tube mount	1
5	Tube holder spacer for carbon tube mount	1
6	Camera spacer for carbon tube mount	1
7	Lens holder	1
8	Hex key 3	1
9	Hex key 5	1
10	1/4" camera mount screw – long	1
11	3/8" camera mount screw – long	1
12	M4 x 12 bolts	4
13	M6 x 45 bolts	2
14	M6 x 20 bolts	8



PDMOVIE lens motor package

ID	Part	Quantity
1	PDMOVIE lens motor	1
2	Lens LEMO Cable	1
3	Lens strip (compatible with 40-70mm lens)	1
4	Zip tie (2.5x90mm)	2
5	Zip tie (5x120mm)	2
6	Additional gear wheels	3

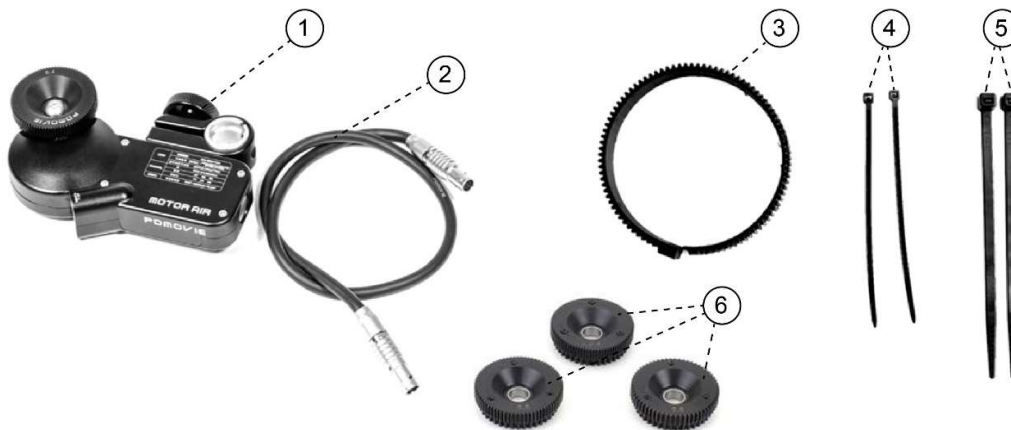

Additional mounting plate set

ID	Part	Quantity
1	Camera mounting plate	1
2	1/4 mount screw - short	1
3	3/8 mount screw - short	1



Fujinon lens cable (10-pin)



Fujinon lens cable (20-pin)



Canon lens cable (20-Pin)



Lanc cable 2.5mm



Panasonic cable 3.5mm



C70/C80 Canon camera Power Supply cable



Ethernet cable

Custom made with desired cable length and possibility for locking mechanism option on both or only one end.



XLR cable for camera supply



Skaarhoj PTZ Extreme configurable controller package

ID	Part	Quantity
1	Skaarhoj PTZ Extreme controller	1
2	12V power supply	1
3	USB programming cable	1
4	Networking cable	1



Aida VISCA controller



RoboStick joystick



Peli case for Pauli / PauliB

Peli case can be used to store and carry Pauli head, as well as all the accessories (apart from Skaarhoj joystick and the manual handle).



Manual handle package

Manual handle package is made for those who want to be able to manually move the Pauli head at any point.

ID	Part	Quantity
1	Manual handle	1
2	Hex key 4	1
3	M5 x 20 bolts	2

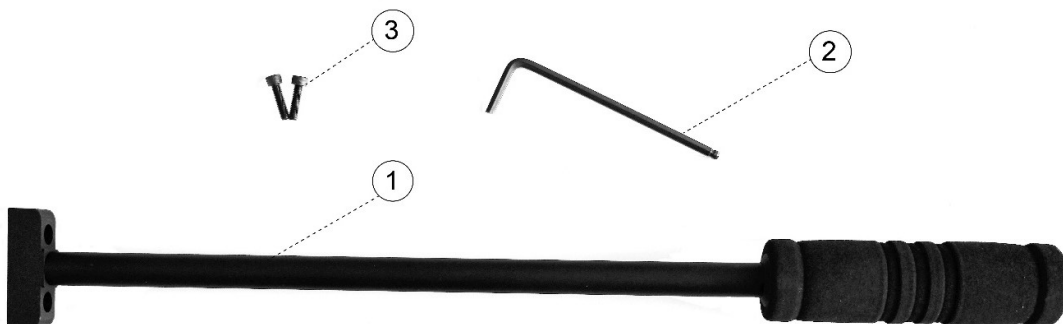

RoboProd rack mount PC with control software

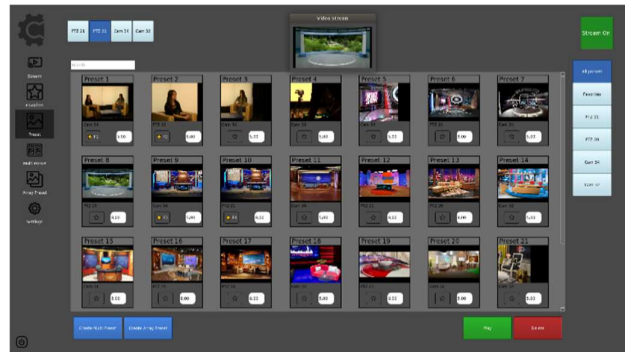

Warranty

The warranty period for the robotic head is 2 years (24 months), with the possibility of extension at an additional cost of 1,000 EUR for each additional year.

Technical support

Technical support is available around the clock, with a response time of 3 hours on any technical question.

Fast replacement and repair available during the warranty period - replacement of the malfunctioning head within 3 workdays. Possibility to buy this service outside the warranty period.